

The background of the image is a blurred photograph of a person wearing a white shirt, holding a smartphone in their right hand. A rainbow is visible in the lower right corner of the frame. The overall image has a dark, semi-transparent overlay.

blacklinesafety

The Loner SMD/IS Safety System

CONTENTS

About the device
Starting your shift
During your shift
Generating Manual Alerts
Ending your shift
Questions?



ABOUT THE DEVICE

There are three primary mechanical components of the Loner device.

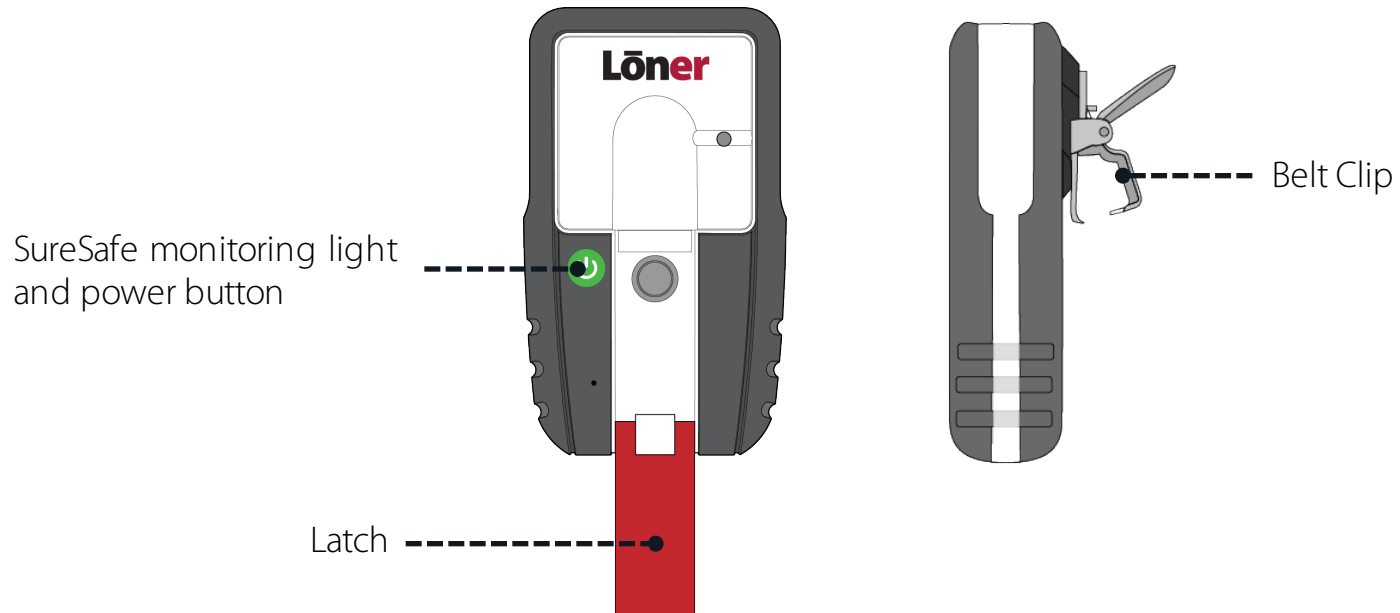

A hand wearing a brown work glove holds a red and white medical device, likely a pulse oximeter, against a blurred background of a person in a high-visibility vest. The text "STARTING YOUR SHIFT" is overlaid in the center.

STARTING YOUR SHIFT

TURNING ON YOUR LONER

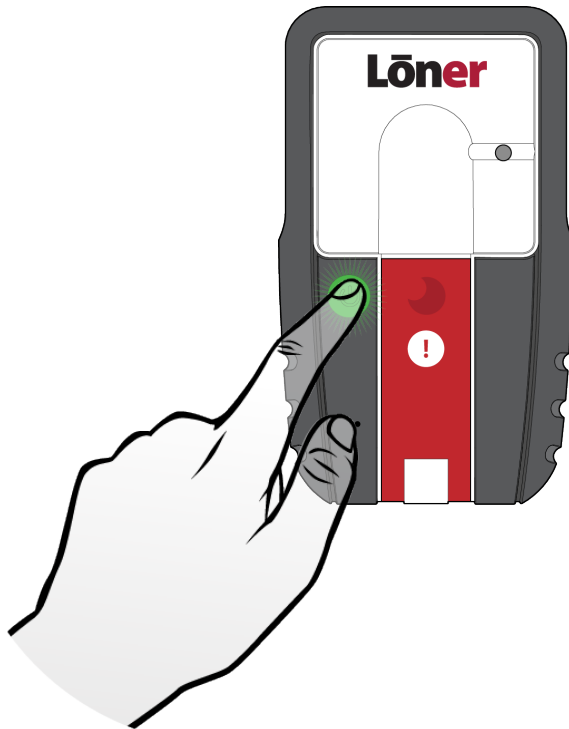

Press the power button

The green SureSafe light will blink until it is connected to the Blackline Safety Network.

Once connected, the light will be **SOLID GREEN.**

This means your safety is now monitored.

WEARING YOUR LONER

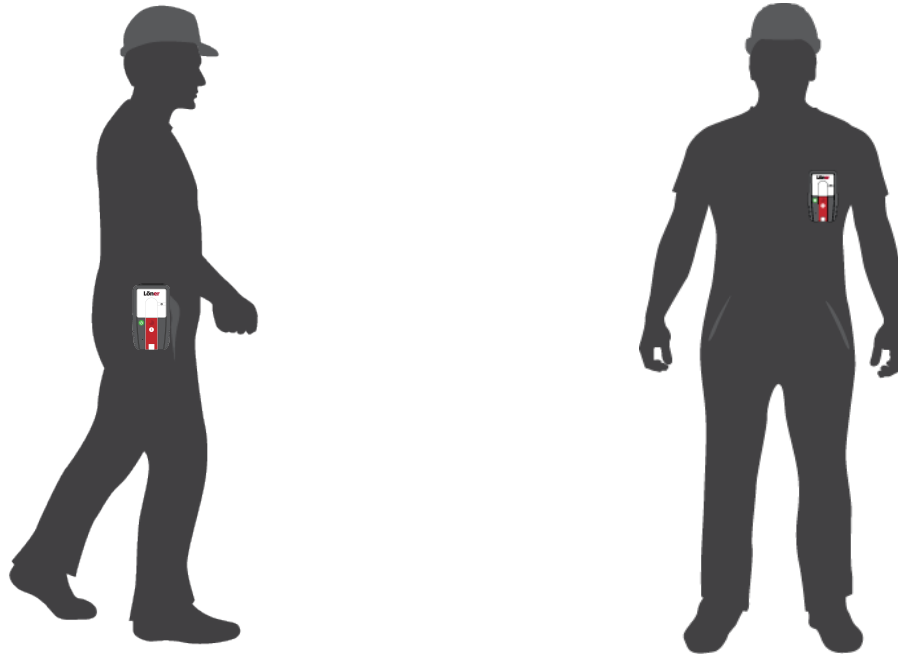

Clip the device to the side of your hip or to your chest pocket

Do not leave Loner unattended when powered on

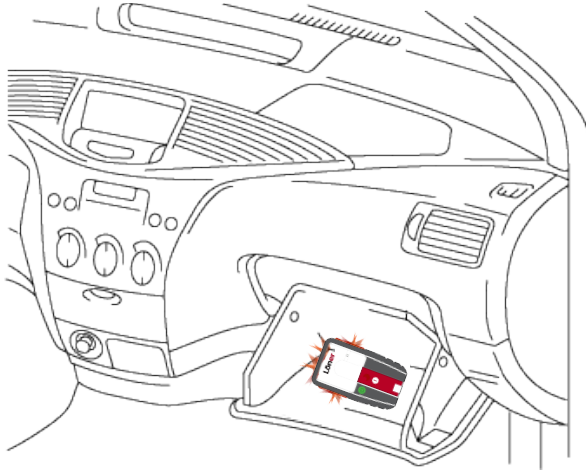

This can lead to false alerts



DURING YOUR SHIFT

AUTOMATIC FEATURES

During your shift, the device may ask you to confirm that you are OK when it detects one of the following:

No-motion



Fall detection

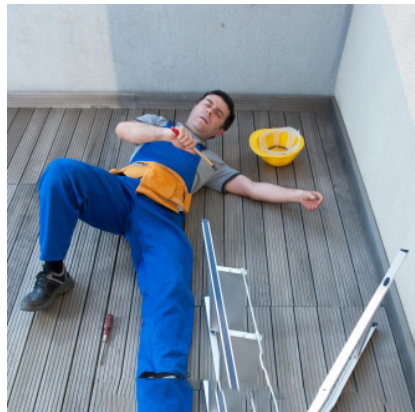

Check-in



AUTOMATIC FEATURES – IF YOU'RE OK

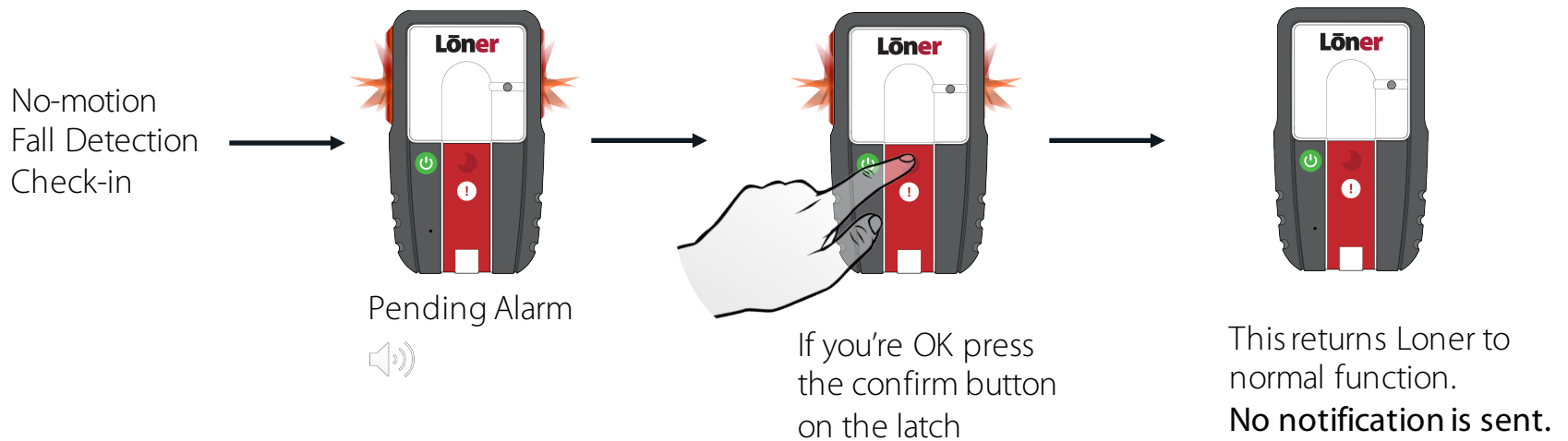

AUTOMATIC FEATURES – IF YOU CAN'T CONFIRM

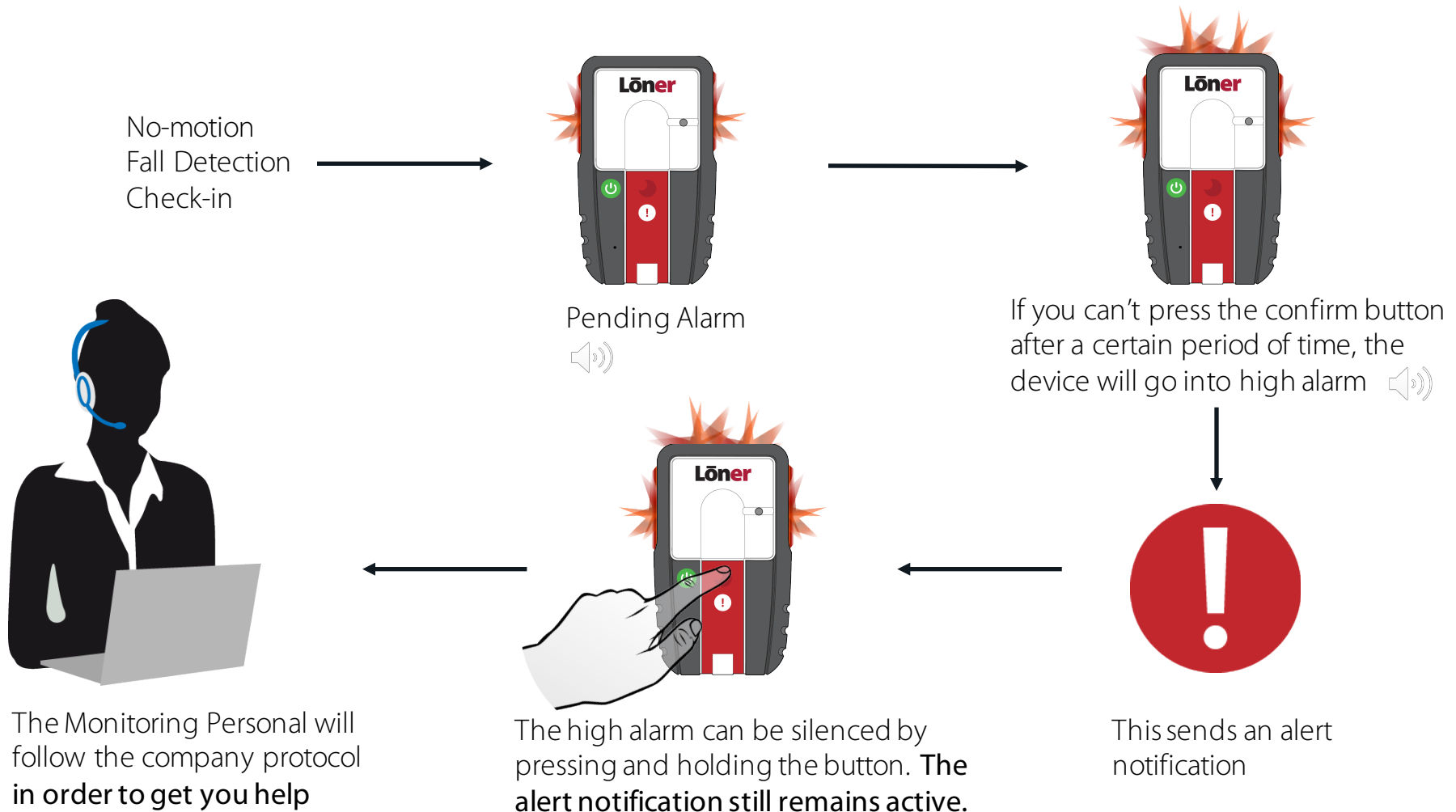

MANUAL FEATURES

During your shift, you may need to request help using one of the manual features:

Emergency alert
(Audible)



Silent alert



Emergency alert

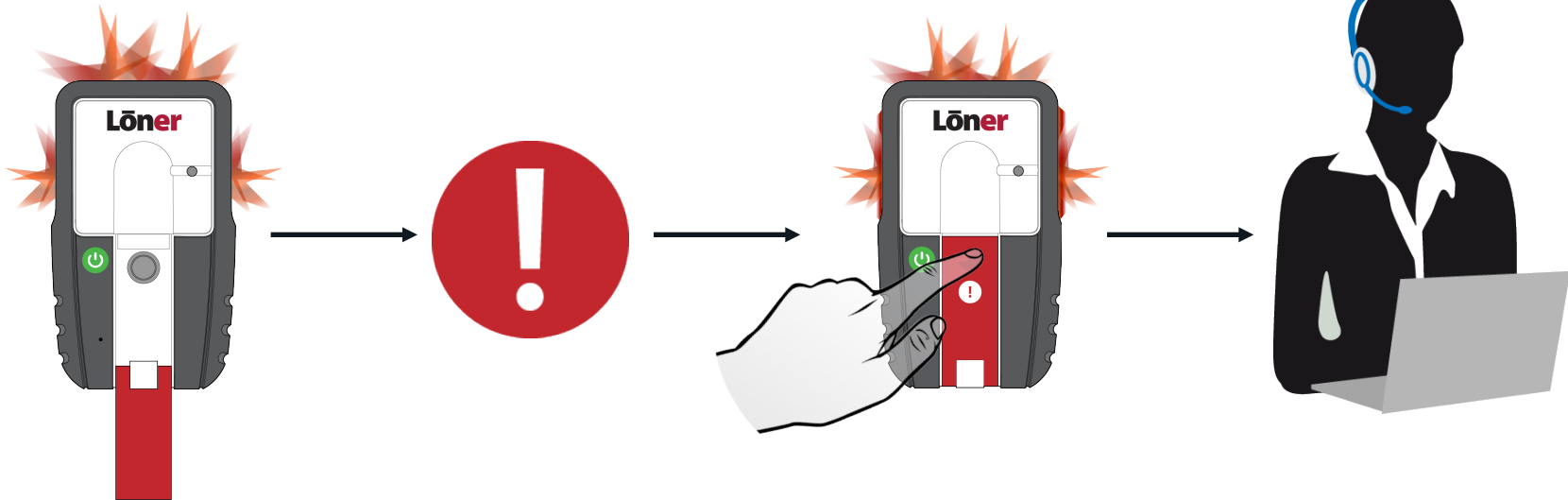

Request help by pulling down the latch



An **alert notification** will be sent to monitoring personnel

The high alarm can be silenced by pressing and holding the button. **The alert notification still remains active.**

Monitoring personnel will work to resolve the alert.

Silent Alert

(No audible or visual alarm is generated on the Loner device)

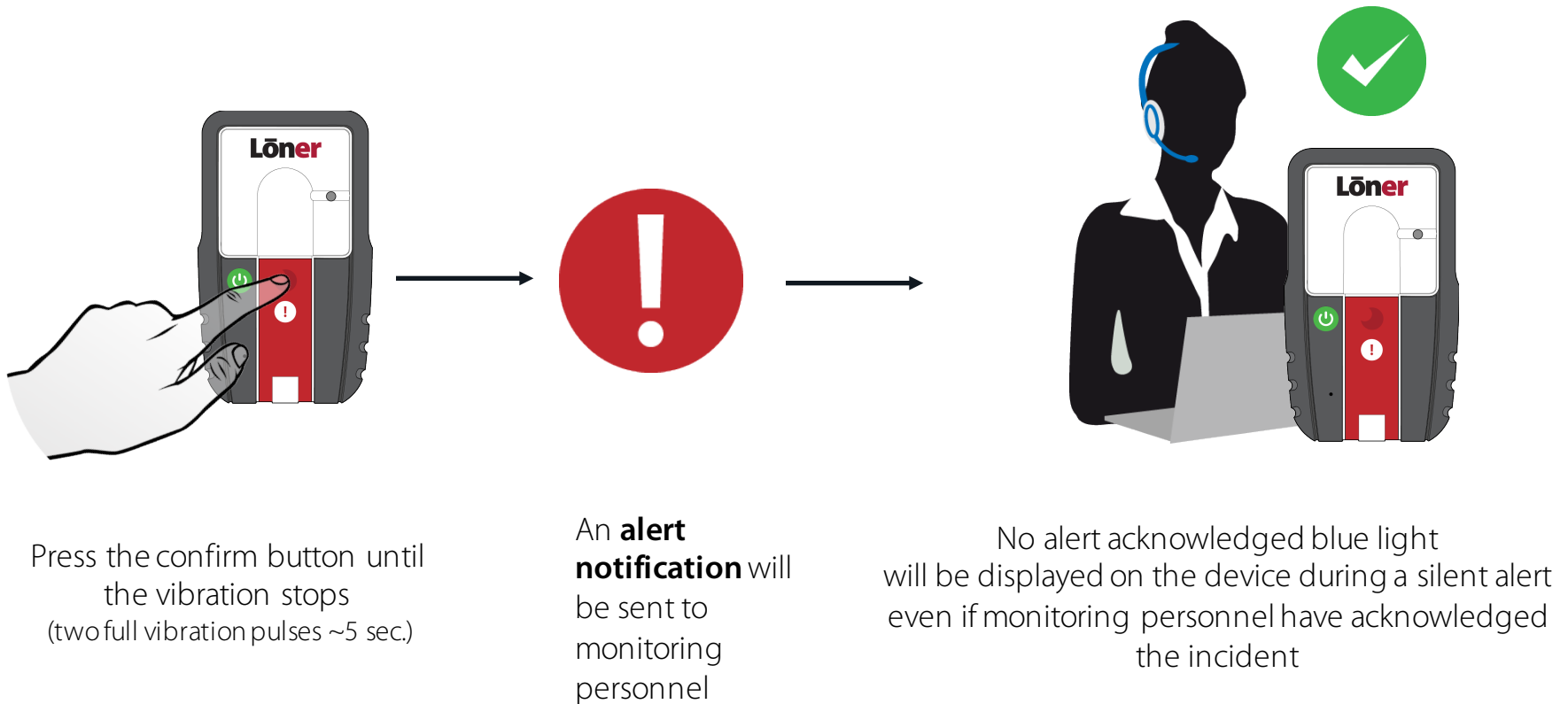

A close-up, slightly blurred image of a hand holding a smartphone. The phone is dark-colored, and a small, glowing green notification bubble is visible on the screen. The background is dark and out of focus.

NOTIFICATIONS

Link lost alarm

Your Loner will notify you if it loses cellular communication.



Your Loner SureSafe light will begin blinking to confirm that your safety is not being monitored. If configured, the device may initiate a link lost alarm.



Low battery alarm

Your Loner device is configured to signal to you when the battery falls below a certain configured percentage



Low battery alarm is characterized by a short beep and a quick flash every 5 minutes. Charge your device as soon as possible.



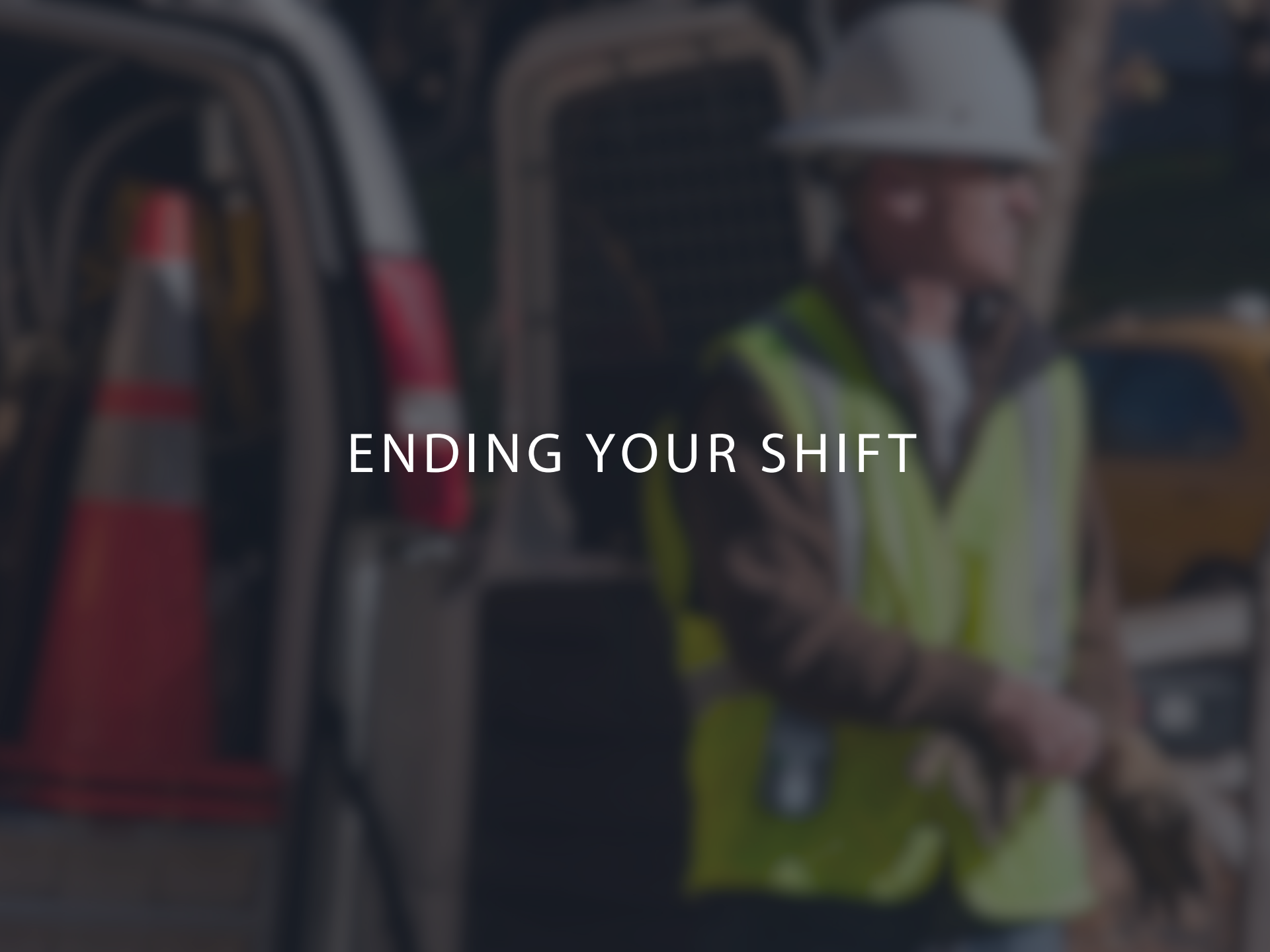

ENDING YOUR SHIFT

TURNING OFF YOUR LONER DEVICE



Press the power button until beeping and vibration stops (usually 3 seconds)

The device will begin its shutdown sequence and the SureSafe light will flash and then turn off once your Loner logs off from the Blackline Safety Network.

Your safety is no longer being monitored

CHARGING YOUR LÖNER

Full charge takes approx 4 hours
Battery Life is 20 hours

Insert the charger into the bottom of the device and connect to power source

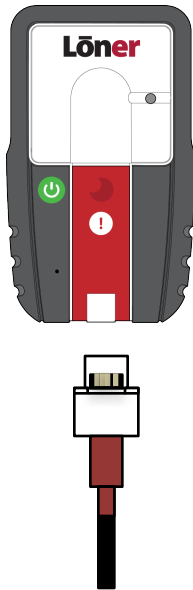

While the device is charging the red lights on the base will flash

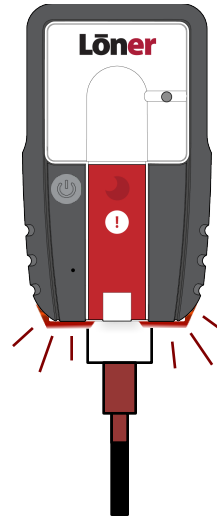

When Löner is charged, the red lights will turn on continuously.

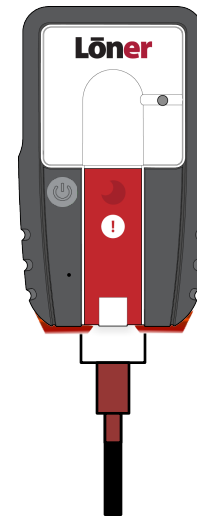



QUESTIONS?



For more support materials,
Please visit support.blacklinesafety.com

Customer Care: 1-877-869-7212