



**blackline**safety

The Loner Bridge System

---

# CONTENTS

About the devices

Starting your shift

During your shift

Generating Manual Alerts

Ending your shift

Questions?



# ABOUT THE DEVICES

# HOW DO LONER BRIDGE & LONER 900 WORK TOGETHER?

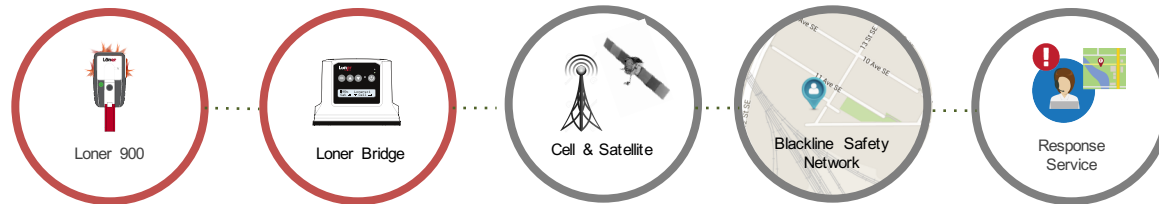

The Loner Device is the monitor and the Bridge is the communicator.



# LONER BRIDGE COMPONENTS

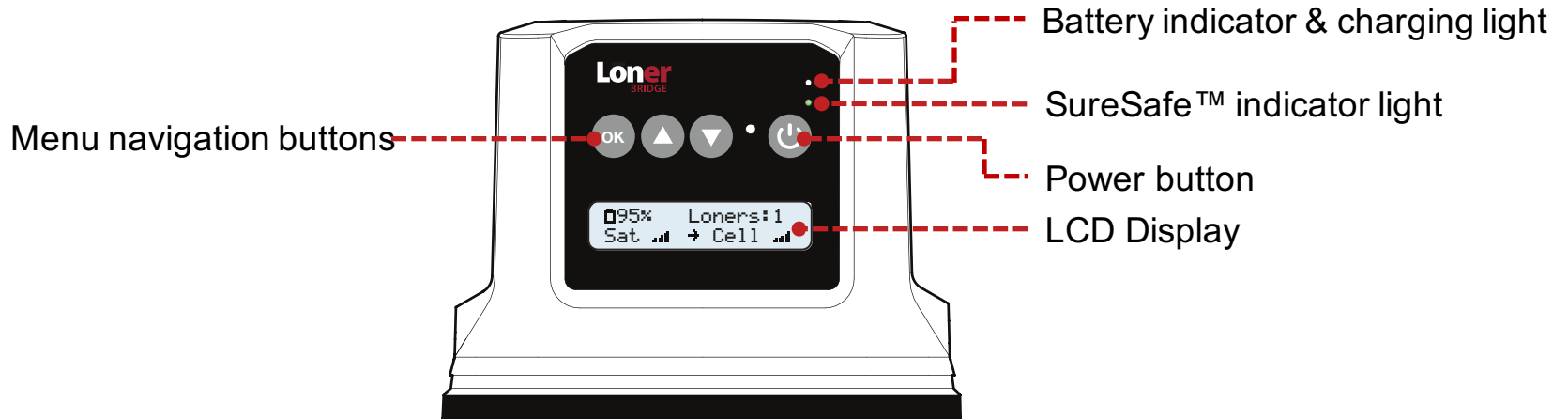

# LCD EXPLAINED

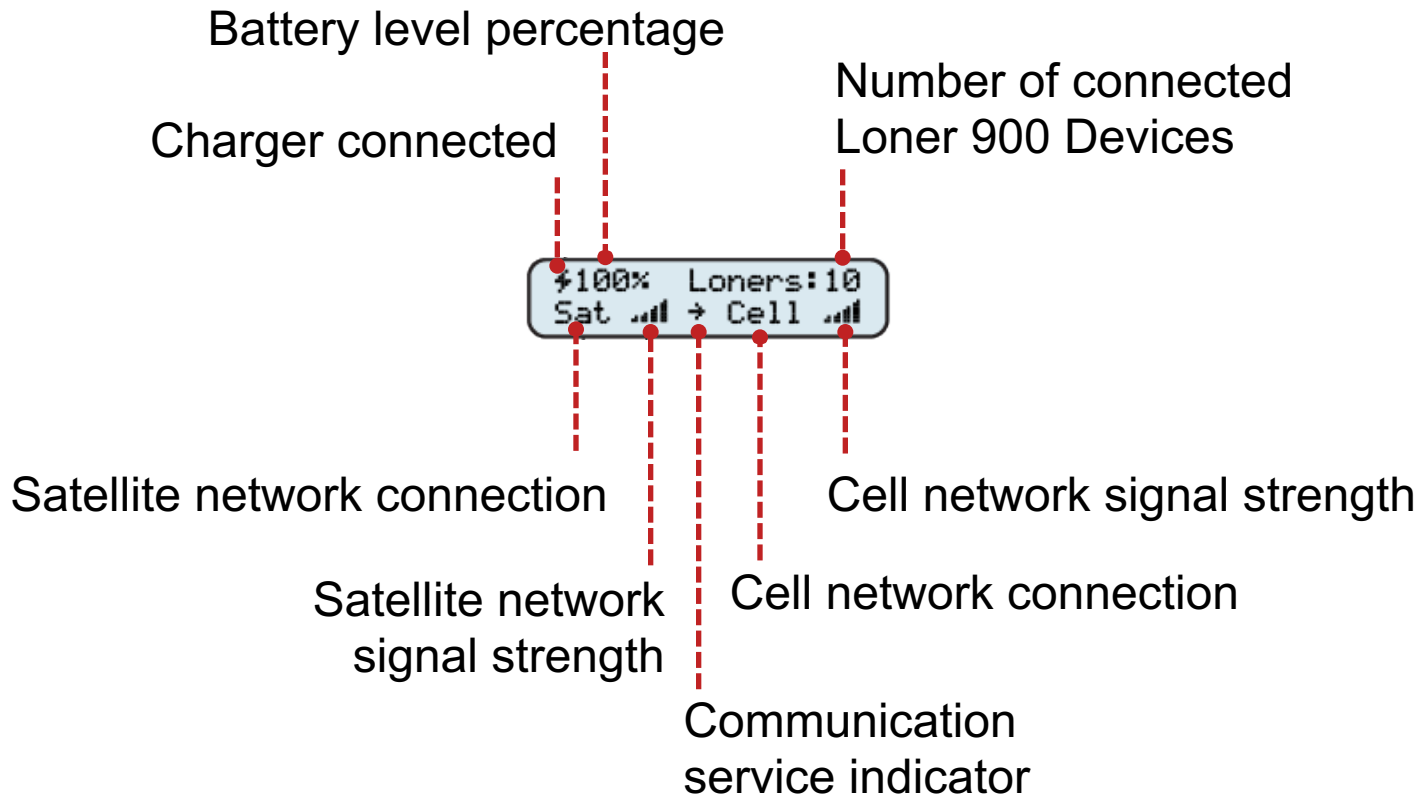

## LONER 900 COMPONENTS

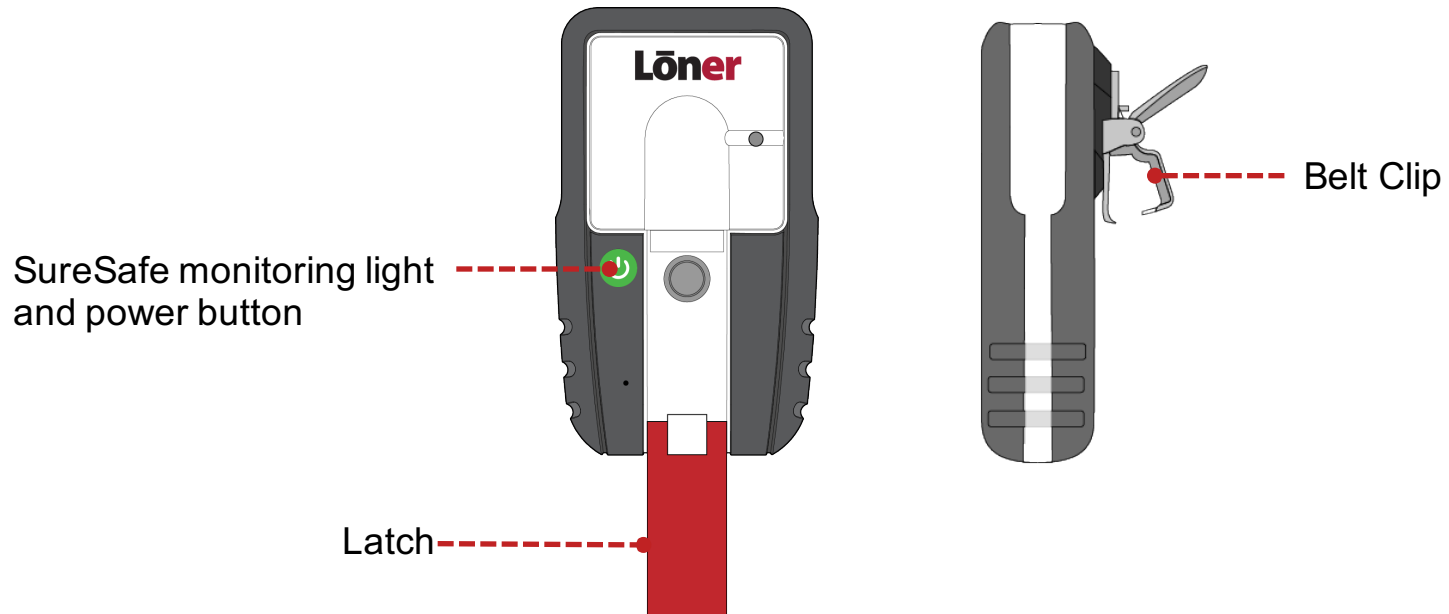

A pair of hands, one light-skinned and one dark-skinned, are shown holding a smartphone. The background is a colorful, abstract pattern with shades of red, green, blue, and orange. The text "STARTING YOUR SHIFT" is overlaid in the center in white, bold, uppercase letters.

STARTING YOUR SHIFT

**ALWAYS** turn Loner Bridge on  
**BEFORE** turning on Loner 900

①



②

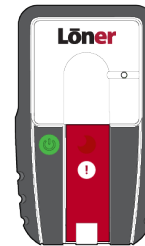

## TURNING ON YOUR LONER BRIDGE

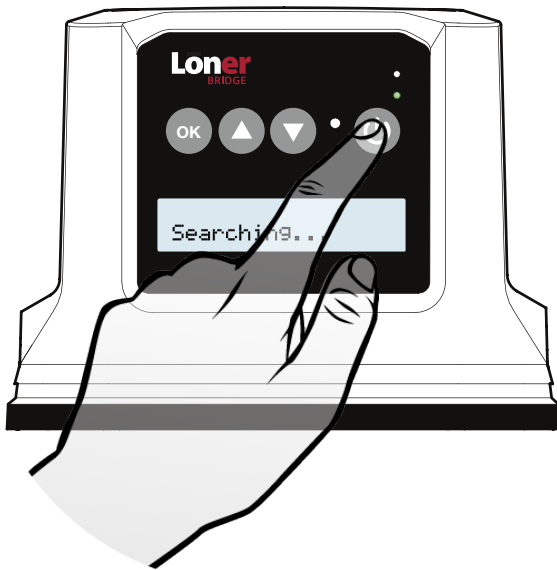

Press the power button

The green SureSafe indicator light will flash while Loner Bridge connects to a network and the LCD will say "Searching..."

Once connected, the SureSafe monitoring light will be **SOLID GREEN**

Ensure the top of Loner Bridge has a clear view of the sky, especially if you are outside of cell coverage

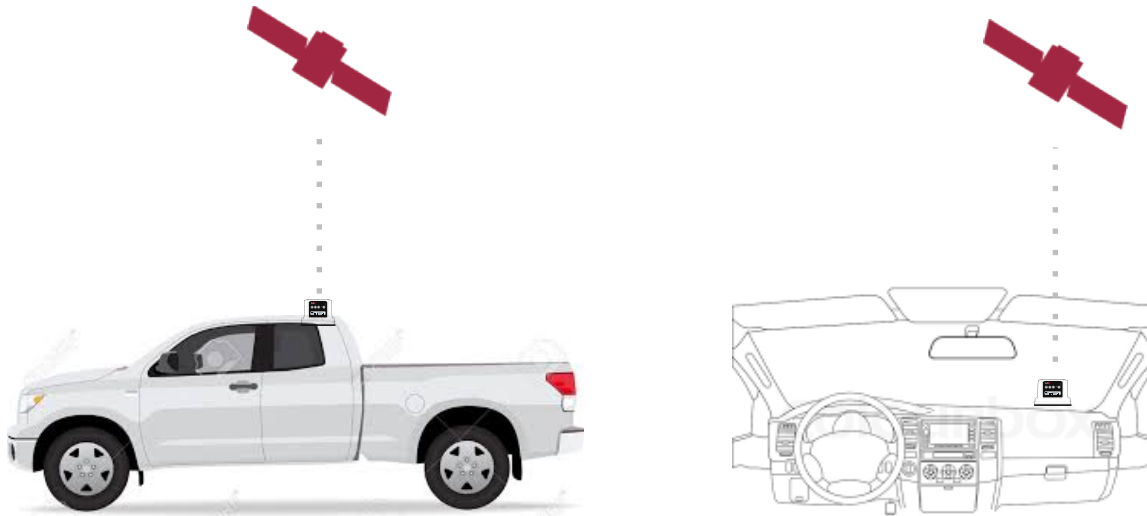

If the SureSafe indicator light on Loner Bridge is flashing, the device is not connected to the Blackline Safety Network and your safety is not monitored

## TURNING ON YOUR LONER 900

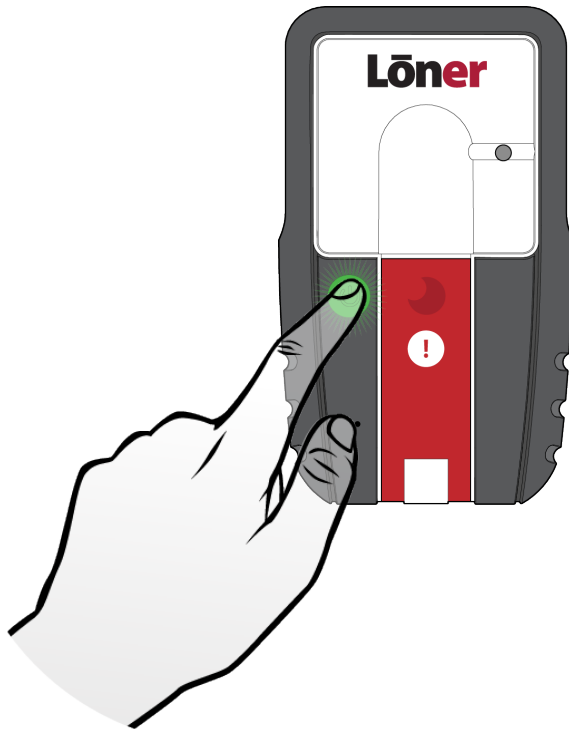

Press the power button

The green SureSafe light will blink until it is connected to the Blackline Safety Network.

Once connected, the light will be **SOLID GREEN.**

This means your safety is now monitored.



## WEARING YOUR LONER

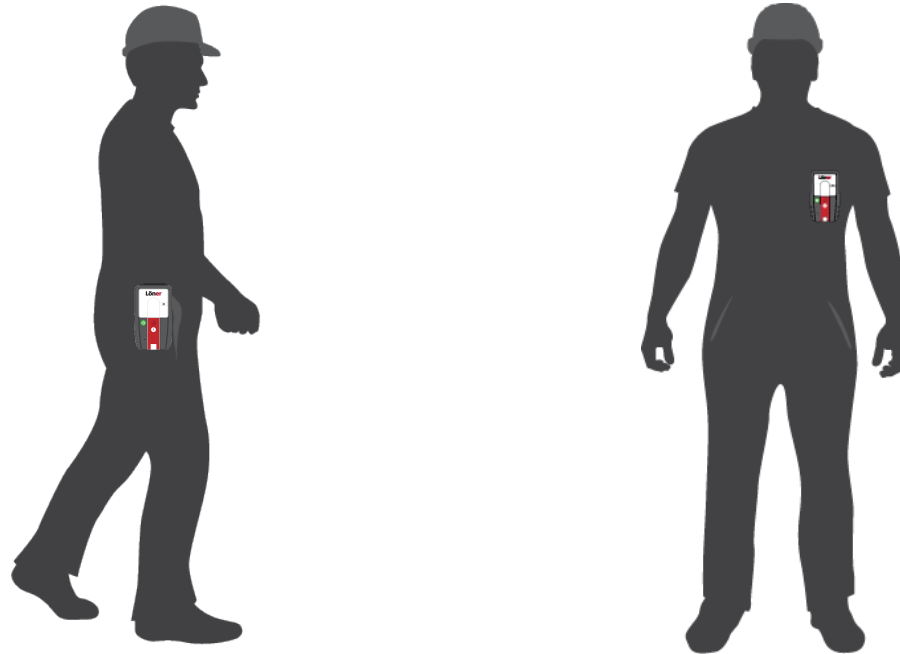

Clip the device to the side of your hip or to your chest pocket

Do not leave Loner unattended when powered on

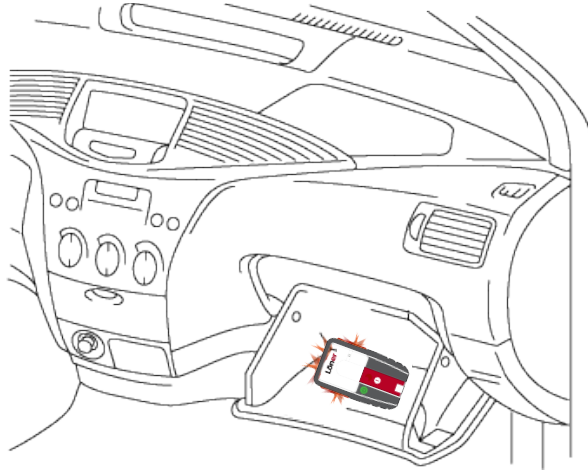

This can lead to false alerts



DURING YOUR SHIFT

# AUTOMATIC FEATURES

During your shift, the device may ask you to confirm that you are OK when it detects one of the following:

No-motion



Fall detection

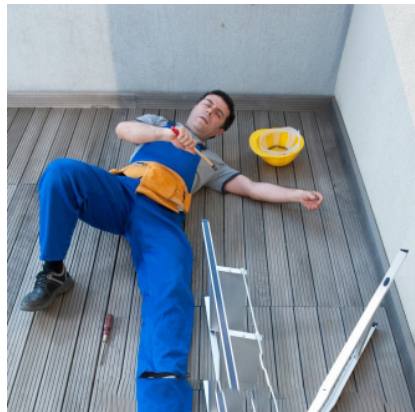

Check-in



## PRE CHECK-IN

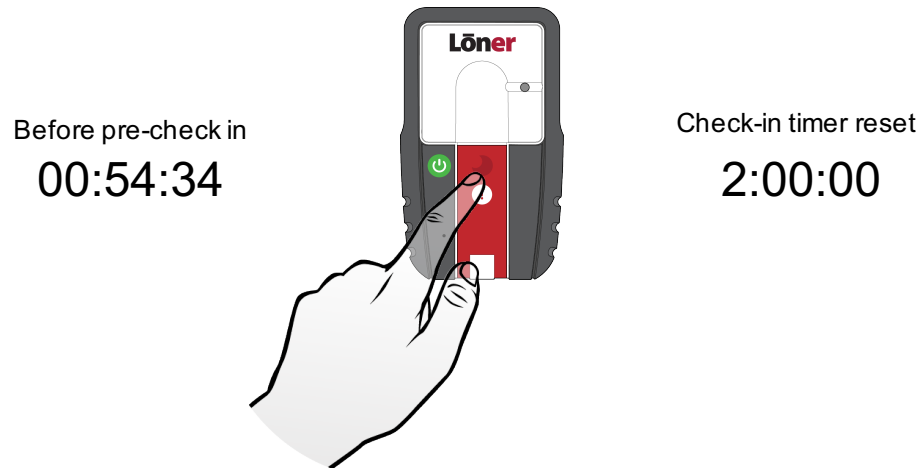

To do this, press and hold the latch for two vibrations. This will reset the check-in timer before the automatic alarm sounds.

Your device will automatically check you in if you are driving over 35 km/h.

## AUTOMATIC FEATURES – IF YOU’RE OK

No-motion  
Fall Detection  
Check-in



Pending Alarm

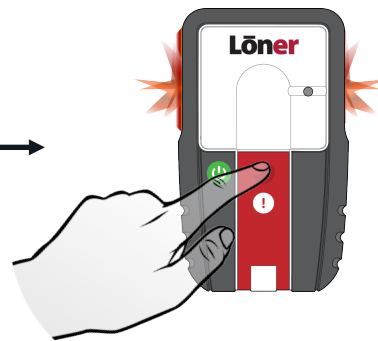

If you're OK press  
the confirm button  
on the latch

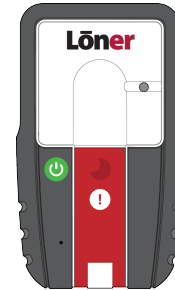

This returns Löner to  
normal function.  
No notification is  
sent.

# AUTOMATIC FEATURES – IF YOU CAN'T CONFIRM

No-motion  
Fall Detection  
Check-in



Pending Alarm



If you can't press the confirm button after a certain period of time, the device will go into high alarm 



This sends an alert notification

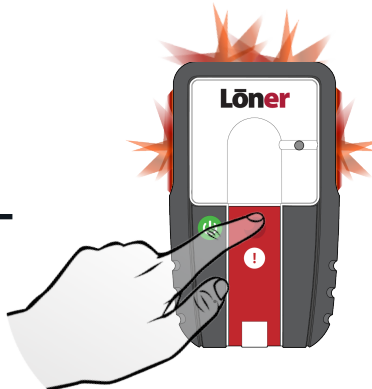

The high alarm can be silenced by pressing and holding the button. The alert notification still remains active.



Once an alert is acknowledged by monitoring personnel, the löner will display a blue light

## MANUAL FEATURES

During your shift, you may need to request help using one of the manual features:

Emergency alert  
(Audible)



Silent alert





## Emergency alert

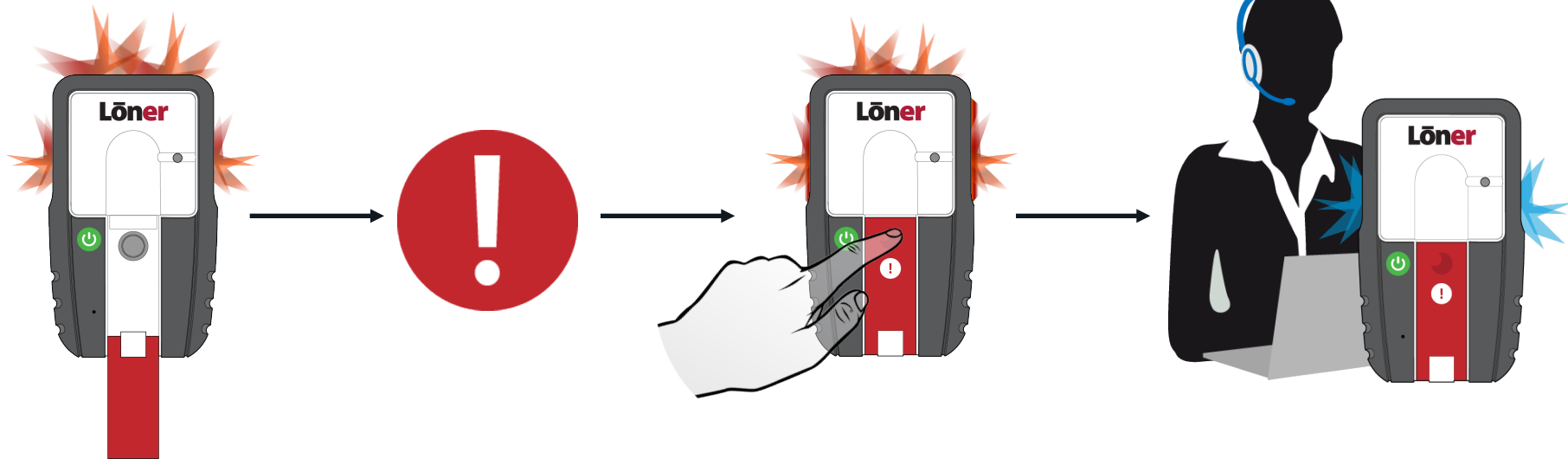

Request help by pulling down the latch



An alert notification will be sent to monitoring personnel

The high alarm can be silenced by pressing and holding the button. The alert notification still remains active.

Once an alert is acknowledged by monitoring personnel, the loner will display a blue light

## Silent Alert

(No audible or visual alarm is generated on the Loner device)

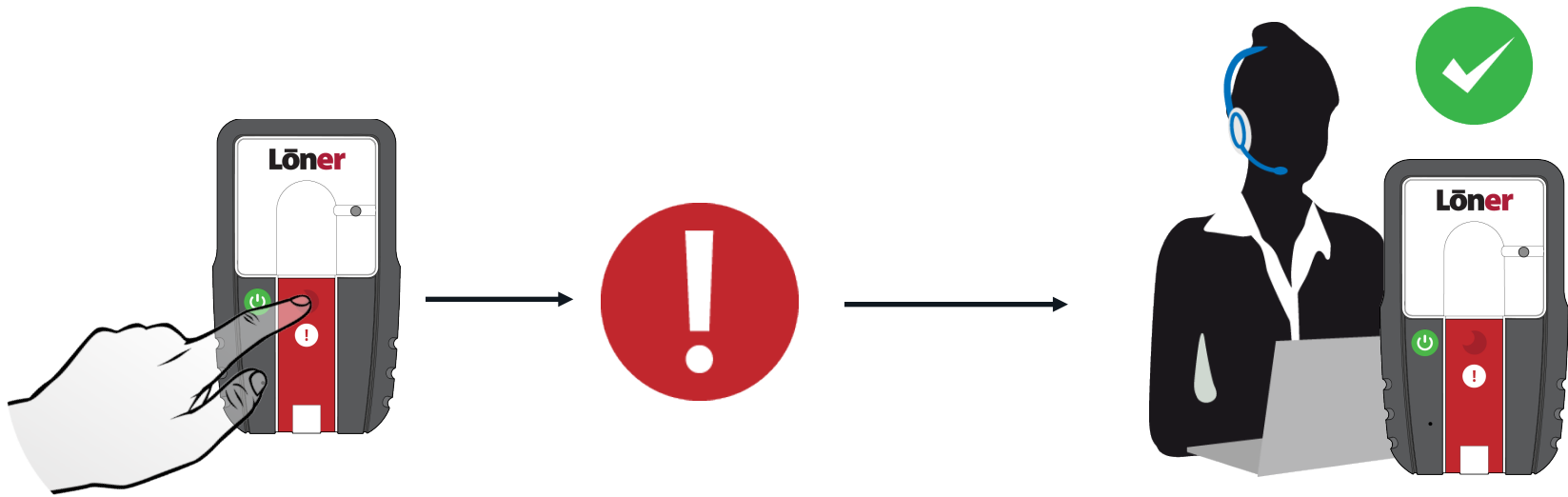

Press the confirm button  
until the vibration stops  
(two full vibration pulses ~5 sec.)

An alert  
notification will  
be sent to  
monitoring  
personnel

No alert acknowledged blue light  
will be displayed on the device during a silent  
alert even if monitoring personnel have  
acknowledged the incident



# BRIDGE MESSAGING

The purpose of Bridge Text Messaging is for the device user to communicate to the monitoring personnel via their Bridge in areas where there is no cell service or cell phones are prohibited.

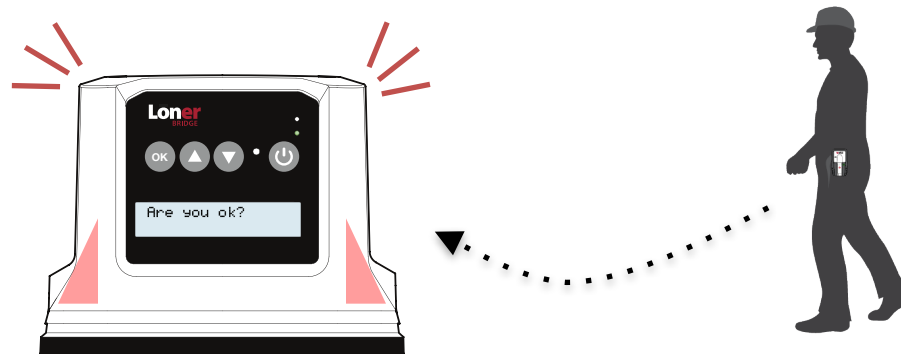

# WHAT HAPPENS WHEN YOU RECEIVE A MESSAGE

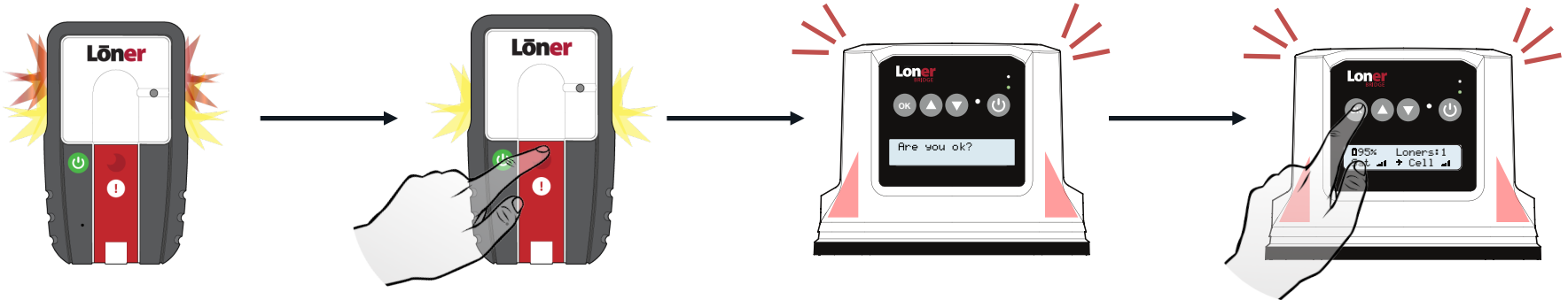

When Bridge receives a message your Loner 900 will muster



To silence your muster alarm press down on the latch for 3 seconds

Return back to your Loner Bridge and check the LCD display for a message from Monitoring Personnel  
Ensure you read the message before moving to the next step



Silence your Bridge by pressing the OK button three times.

# REPLYING TO A TEXT MESSAGE

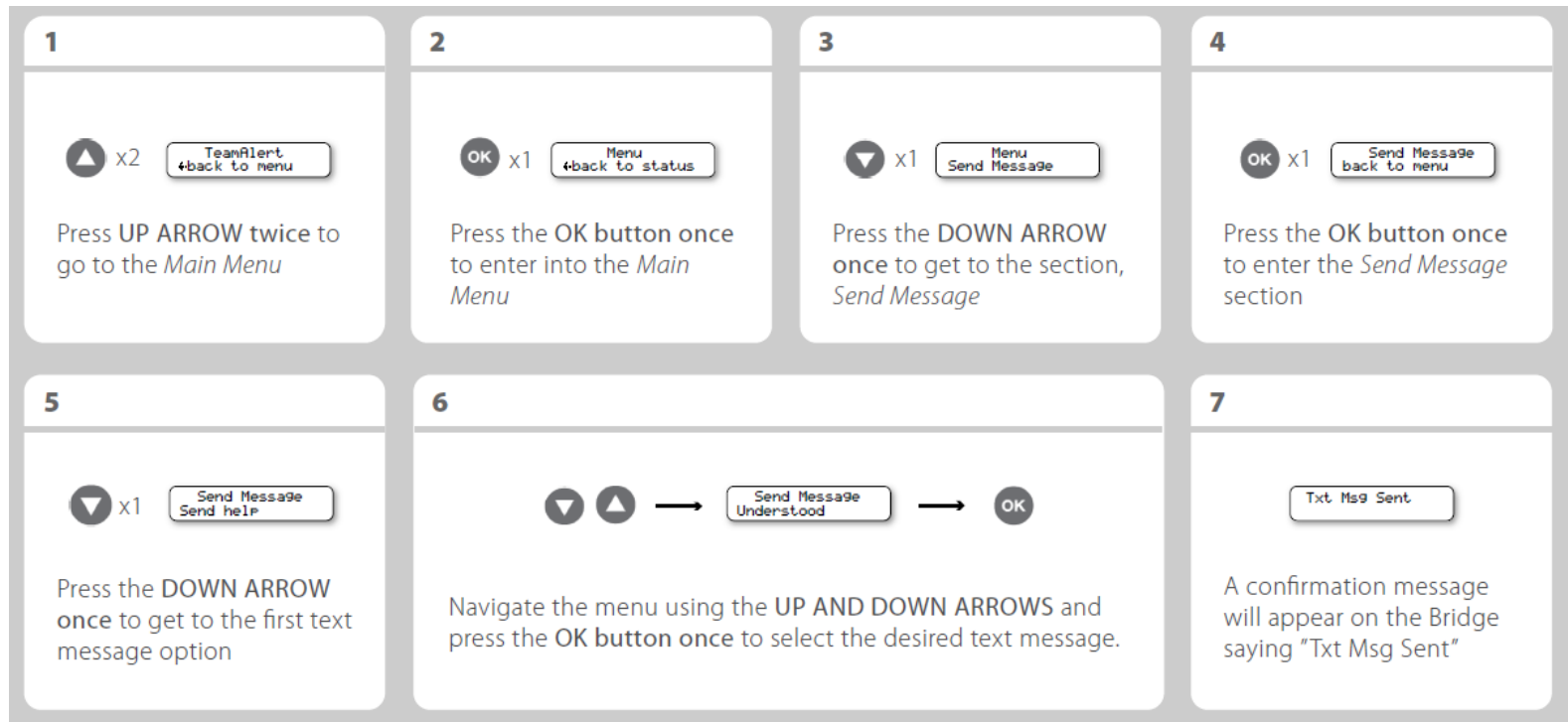

A person wearing a bright red safety suit and a black hat stands next to a white van in a snowy, outdoor setting. The person is leaning against the van, and their right arm is raised towards the roof. The background is a blurred, snow-covered landscape. The text "BRIDGE MUSTERING" is overlaid in white, bold, sans-serif font in the center of the image.

# BRIDGE MUSTERING

# STARTING A MUSTER FROM A BRIDGE

The purpose of the Muster is to call employees back to the Bridge

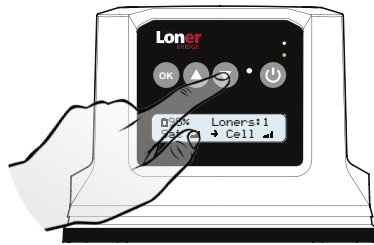

Press the down button  
4 times until you see  
TeamAlert Muster

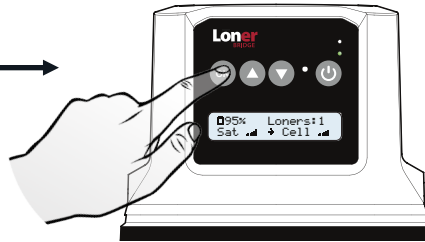

Press OK

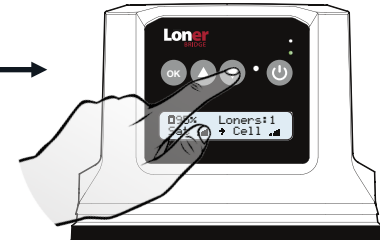

Press the down button  
until you see start

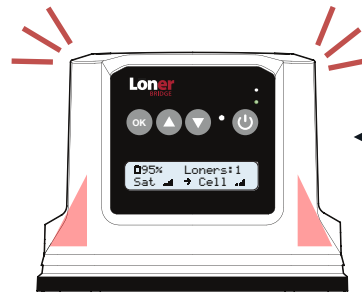

This will start a team  
muster and the Bridge  
will go into alarm 🔊

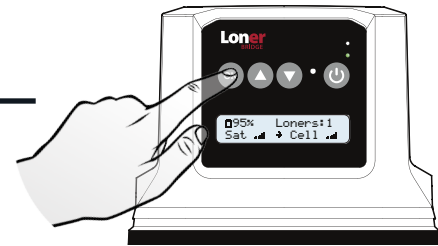

Press OK



# RECEIVING A MUSTER ON THE LONER 900



When a muster is generated, your Loner 900 will display the muster alarm



To silence your device, press and hold the latch for 3 seconds. Once silenced the device will display only the solid yellow light.

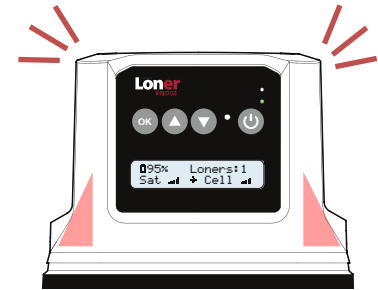

Return back to your bridge



# ENDING A MUSTER FROM A BRIDGE

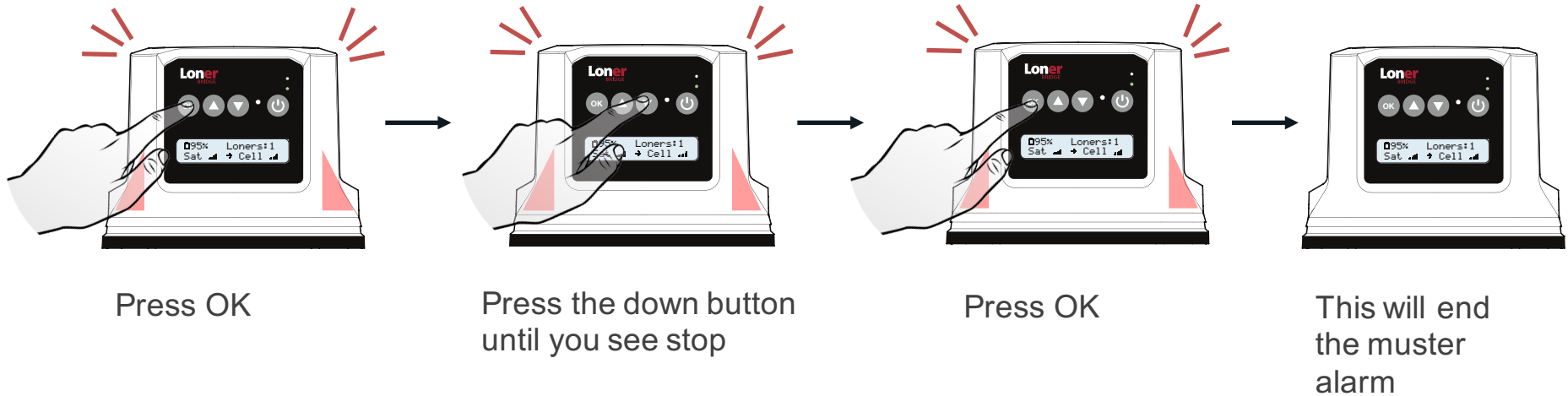

A close-up, slightly blurred photograph of a person's hand holding a smartphone. The phone's screen is lit up, showing a notification icon with a red and green dot. The background is a dark blue, textured surface, possibly a jacket or shirt. The overall lighting is soft and focused on the hand and phone.

NOTIFICATIONS

## Link lost alarm

Your Loner 900 may be configured to notify you if it loses connection with Loner Bridge.

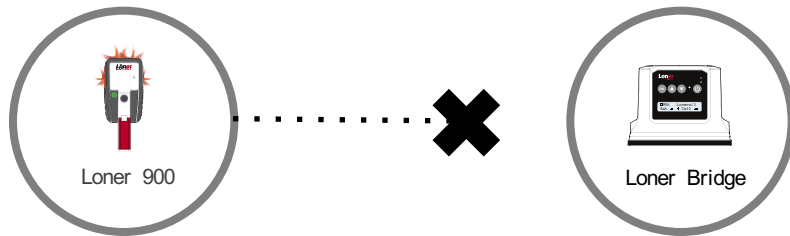

If configured, the device may initiate a LINK LOST ALARM, which is characterized by a chirp every 5 minutes. If you hear this, head back to your Bridge.

Your Loner 900 SureSafe light will begin blinking to confirm that your safety is NOT being monitored



## Low battery alarm

Your Loner device is configured to signal to you when the battery falls below a certain configured percentage



Low battery alarm is characterized by a short beep and a quick flash every 5 minutes. Charge your device as soon as possible.





ENDING YOUR SHIFT

## TURNING OFF YOUR LONER DEVICE



Press the power button until beeping and vibration stops (usually 3 seconds)

The device will begin its shutdown sequence and the SureSafe light will flash and then turn off once your Loner logs off from the Blackline Safety Network.

Your safety is no longer being monitored

## TURNING OFF YOUR LONER BRIDGE

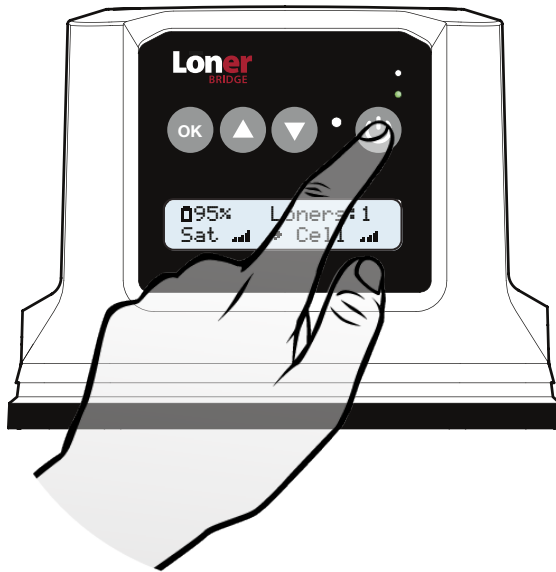

Press the power button and hold for 3 seconds

The device will begin its shutdown sequence and the SureSafe light will flash and then turn off once your Loner logs off from the Blackline Safety Network.

# Always turn Loner 900 off Before turning off Loner Bridge

①

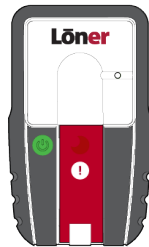

②



Loner Bridge cannot be powered down until the SureSafe light on the Loner 900 has stopped flashing



# CHARGING YOUR LÖNER 900

Full charge takes approx 3 hours  
Battery Life is 24 hours

Insert the charger into the bottom of the device and connect to power source

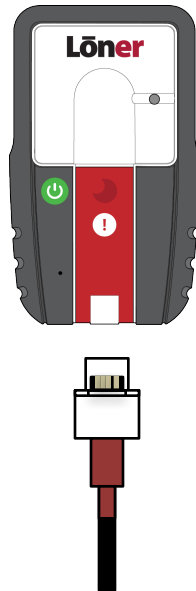

While the device is charging the red lights on the base will flash

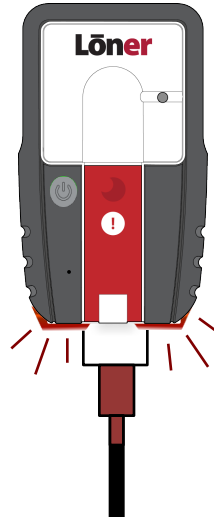

When LÖner is charged, the red lights will turn on continuously.

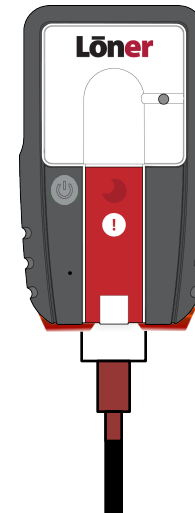

# CHARGING YOUR LONER BRIDGE

Full charge takes approximately 8 hours  
Battery life is 50 hours

Insert the CHARGER into  
the bottom of the device  
and connect to power  
source

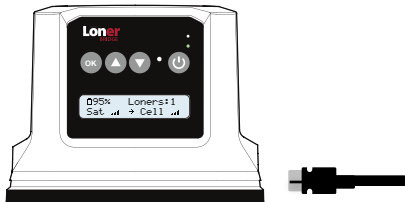

While the device is  
CHARGING the top  
indicator light will flash  
RED

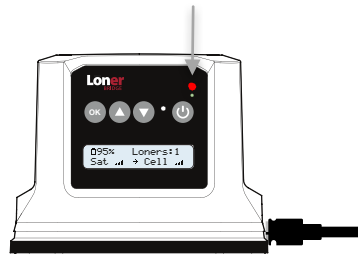

When Loner Bridge is  
charged, the RED light will  
turn on continuously



# SUMMARY

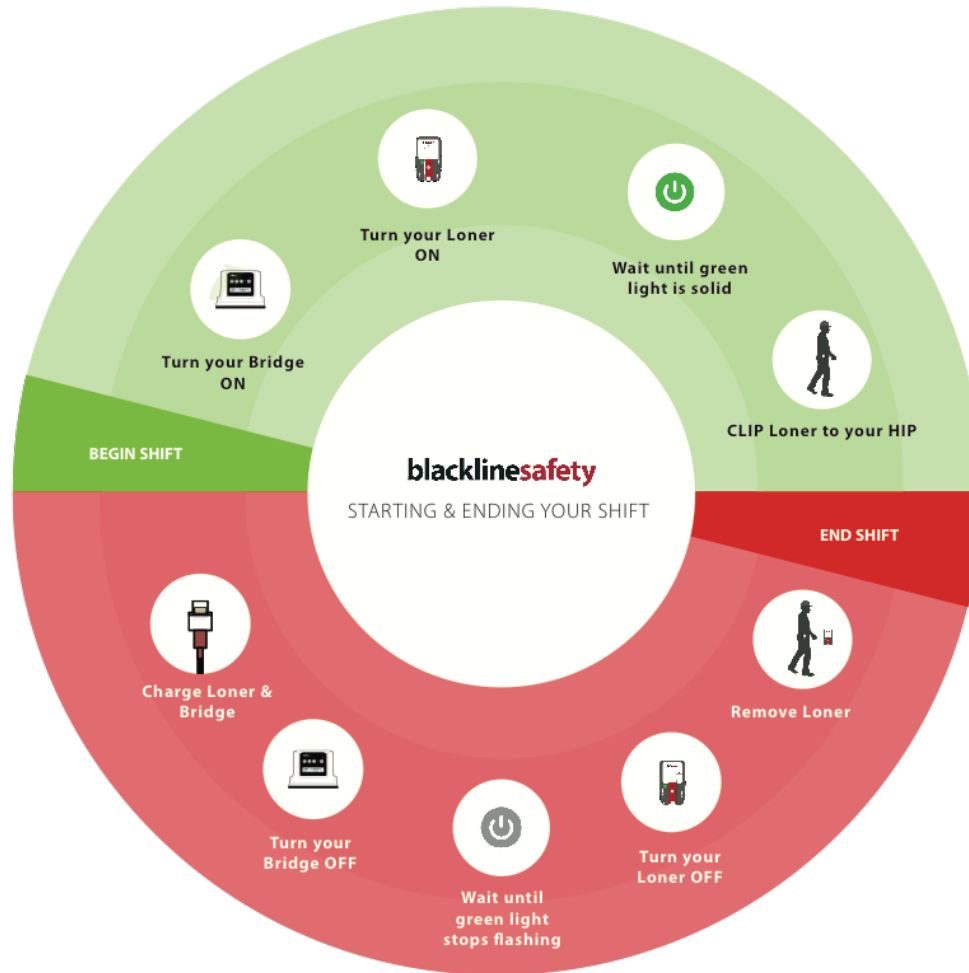

QUESTIONS?

# blacklinesafety

For more support materials,  
Please visit [support.blacklinesafety.com](https://support.blacklinesafety.com)

Customer Care: 1-877-869-7212