

blacklinesafety

G6 DOCK

Getting Started Guide

G6 DOCK

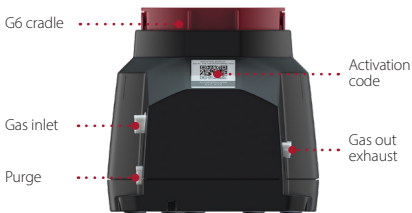

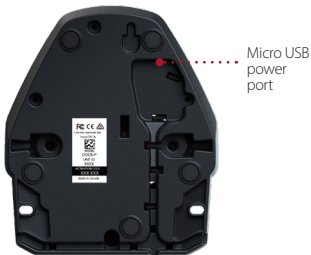

GAS PORT CONFIGURATION

G6 Dock is equipped with a Gas out exhaust, a purge inlet, and a gas inlet.

Gas Out Exhaust

Viewed from the back of G6 Dock, the Gas out exhaust is the connector on the right. It is used to transfer calibration gas to a safe exhaust location.

WARNING: Never connect a gas cylinder to the Gas out exhaust.

Purge Inlet

Viewed from the back of G6 Dock, the Purge inlet is on the bottom left side. It supplies clean air, removing residual gas from G6 Dock. Blackline recommends attaching the optional dock filter to the Purge inlet when using G6 Dock in dusty or humid environments.

Gas Inlet

Viewed from the back of G6 Dock, the Gas inlet is on the top left side. By default, the Gas inlet is preprogrammed in Blackline Live for H₂S. If your G6 has a sensor other than H₂S, you will need to update your Dock's inlet in Blackline Live.

To update your Dock's gas inlet in Blackline Live:

1. From the Main menu, select **Docks**. The Docks page opens.
2. Select the **G6** tab.
3. Select the dock you want to update. The Dock configuration details page opens.

4. Select **EDIT**.
5. Select your G6 gas sensor from the **Gas** drop down.
6. Enter the calibration gas concentration in the **Concentration** field.
7. Enter the **Gas cylinder** information.
8. Select **SAVE**.
9. When the settings have saved, lock your G6 into the dock and select **Dock update** from the device's Dock menu.

NOTE: You need to be an Account User in Blackline Live to update G6 Dock gas inlet settings. Contact your Blackline Live administrator if you do not have access.

Activation Code

Use the activation code on the back of G6 Dock to find it in Blackline Live. If you cannot see your G6 Dock in Blackline Live, contact our Customer Care team.

POWERING ON G6 DOCK

Connect the power cable to the port on the bottom of the dock. Feed the power cable through the tracks along the bottom to allow the dock to lie flat on a surface.

When plugged in, the green LED light at the front of the dock will turn on to indicate power.



Feed power cable



Green LED light

LOCKING G6 INTO G6 DOCK

To access the following G6 Dock functionality, G6 must be locked into G6 Dock's cradle:

- Charging G6
- Bump testing G6
- Calibrating G6
- Accessing the G6 Dock menu

To lock G6 into G6 Dock's cradle:

1. Place G6 into the G6 Dock cradle.
2. Lock G6 into G6 Dock by positioning your fingers over G6's top indicator lights and pressing G6 firmly down into the cradle until the locking mechanism clicks into place.

IMPORTANT: To avoid damaging G6 Dock, do not remove your device by pulling it out of the dock without pushing down the device to unlock the locking mechanism.

1



WARNING: When locking G6 into the dock, press down over the top indicator lights. Do not press down on the antenna, as doing so may cause the data and power contacts to disconnect.

2



CONNECTING GAS

Use the included tubing and quick connects to connect G6 Dock to a gas cylinder.

To connect a gas cylinder to G6 Dock:

1. Attach a quick connect to the provided tubing.
2. Ensure the other end of the tubing is attached to a demand flow regulator on the gas cylinder.
3. Insert the quick connect end into the dock's Gas inlet.
4. Twist the quick connect clockwise until it clicks securely into place.



LEARN MORE

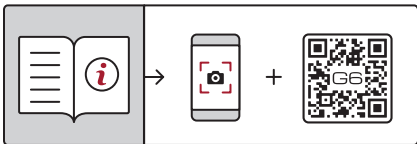

 [SUPPORT.BLACKLINESAFETY.COM](https://support.blacklinesafety.com)



North America

Toll Free: 1-877-869-7212 (24 hours)
support@blacklinesafety.com

Europe/United Kingdom

+44 1787 222684 (8 am-5 pm GMT)
eusupport@blacklinesafety.com

International

+1-403-451-0327 (24 hours)
support@blacklinesafety.com